

Braden's Solid Core Modular "SCM" Radio Frequency shielded panel enclosure system offers durability, flexibility and exceptional performance.



RF Floor and Wall System



RF Wall and Ceiling System

Braden's SCM panel system is constructed of solid core with two sheets of shielding attenuation media.

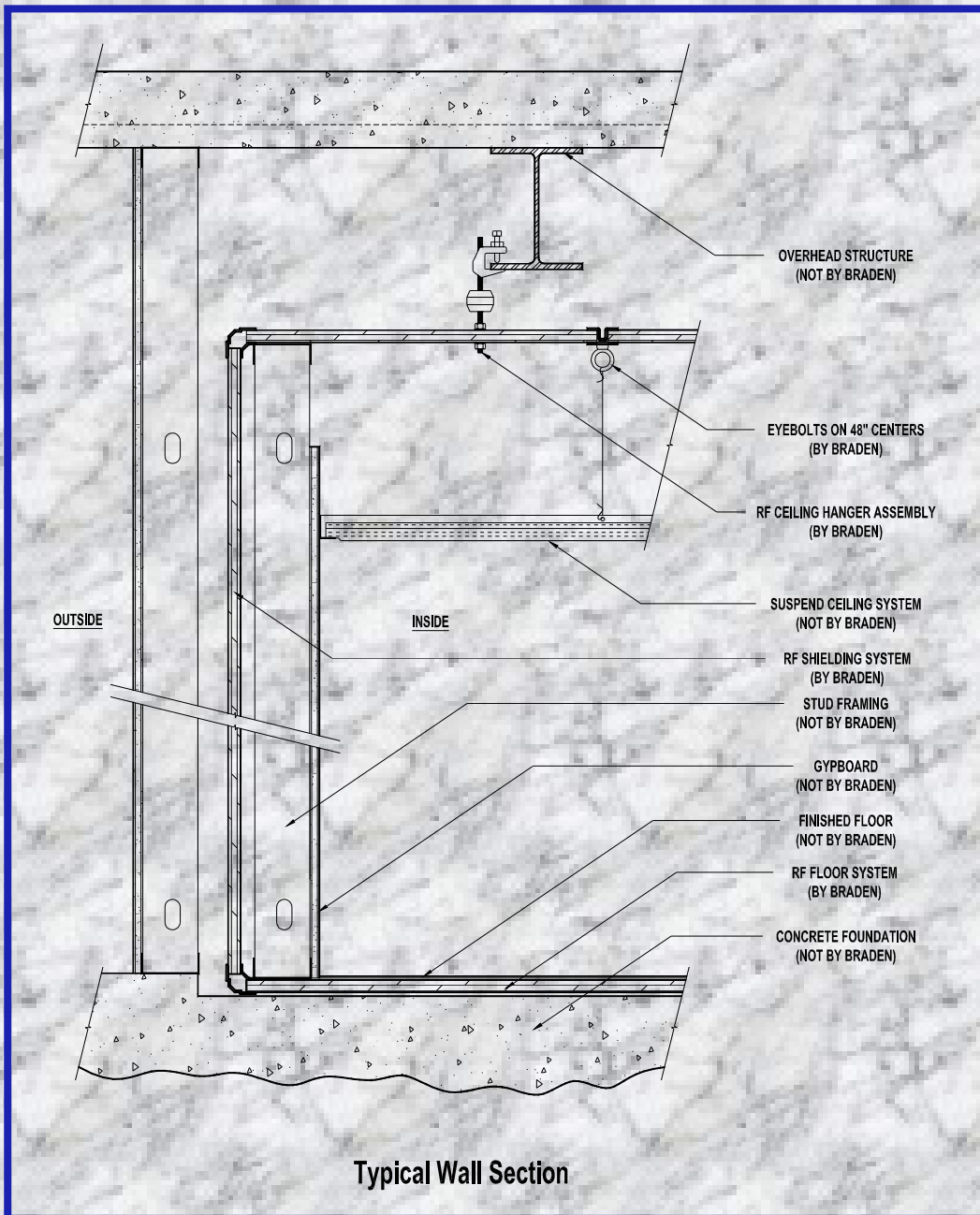

Braden SCM panels are available with various gages of galvanized steel, copper sheet and aluminum to meet the MRI vendor specifications. The SCM panels are clamped together with zinc plated steel, brass or aluminum framing members to provide a continuous Radio frequency seal. Unlike single skin enclosures, this method of construction provides for a durable RF shielded enclosure system that is not easily damaged by other construction trades during the interior finish stage of the construction.

Braden's SCM panel and framing system can be easily field modified to accommodate various width, length and height configurations. This flexibility is also extended to the various mechanical, electrical and pipe penetrations, which can be located in the field.

#### Standard SCM Panel System

- A. The basic enclosure shall be constructed to the proper dimensions consisting of pre-engineered modular panels and their related framing system.
- B. Wall, floor and ceiling panels: All shield panels shall be rigid structural panels, faced on both the interior and exterior sides with galvanized 28 gage steel skins.

Provide necessary attachment channels for the application of interior furring studs.

- C. Panel interlocking system: Shall consist of 11 gauge pre-engineered zinc plated metal framing members. No rigid solder seams shall be permitted. The framing element shall consist of shapes, which will provide a clamping action on both the interior and exterior panel edges. A uniform and constant pressure contact shall be maintained against the entire perimeter of each shielded panel.
- D. Trihedral corners are to be framed with machined cast bronze corner cap assemblies.
- E. Fasteners used within the framing system shall be hardened steel, self-tapping TORX™ head screws set at 90 inch pounds of torque and spaced on 4" centers for the entire perimeter of all shielded panels.



Americas - 9260 Broken Arrow Expressway, Tulsa, OK 74145, USA, Phone: (918) 624-2888 Fax: (918) 624-2886 [www.bradenshielding.com](http://www.bradenshielding.com)  
[info@bradenshielding.com](mailto:info@bradenshielding.com)

Europe and Asia - North Florida Road, Haydock, St Helens, Merseyside, WA11 9TN, UK, Phone: +44 (0) 1942 296190  
 Fax: +44 (0) 1942 275202, [www.rainfordemc.com](http://www.rainfordemc.com) [sales@rainfordemc.com](mailto:sales@rainfordemc.com)